

B.E.G.**LUXOMAT®**

PD4-S-FC Set 92254-92992

- Voltage: 110 - 240 V AC 50 / 60 Hz
- Dimensions: Ø 97 x 103 mm
- Power consumption: approx. 0.2 W

Order data

Designation	Colour	Art.No
PD4-S-FC	white	92254
Square design frame PD4-FC	pure white	92992

Technical data

Voltage:	110 - 240 V AC 50 / 60 Hz
Dimensions:	Ø 97 x 103 mm
Power consumption:	approx. 0.2 W
Detection area:	horizontal 360° (Ceiling mounting) max. Ø 24 m across
Range:	max. Ø 8 m towards max. Ø 6.4 m seated
Monitored area (tangential movement):	450 m ² / 2.5 m mounting height
Mounting height min./max./recommended:	2 m / 10 m / 2.5 m
Degree / class of protection:	IP20 / Class II
Impact strength:	IK04
Ambient temperature:	-25 °C to +50 °C
Housing:	polycarbonate, UV-resistant
Material color:	white mat, similar to RAL9010
Pulse interval:	2 or 9 sec

Product information

Set : PD4-S-FC + Square design frame PD4-FC pure white mat, similar to RAL9010

Slave device detector with extended detection area

For extending the detection area of a Master device

Trigger pulse to master device upon detected movement independent of the ambient light level

Compatible with 230 V devices. Concerning exceptions please see the respective master device.

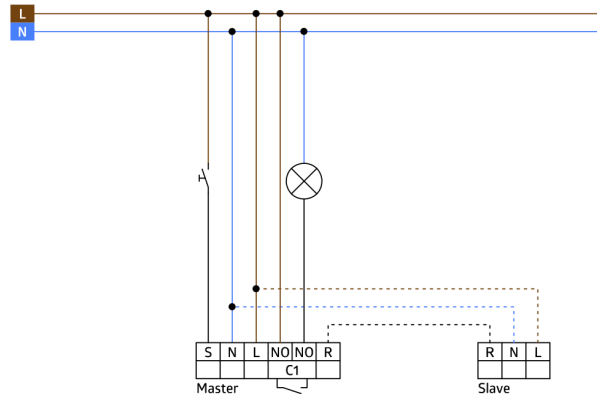
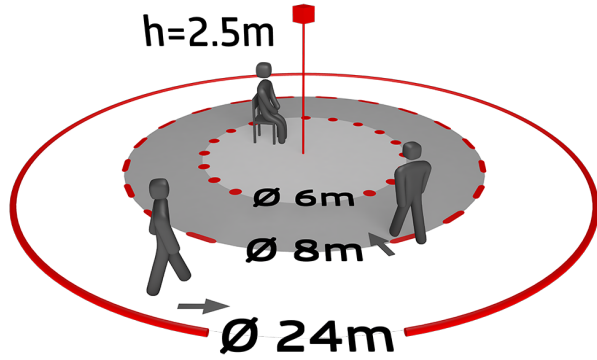
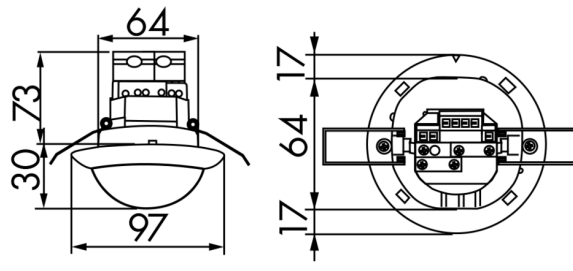

Set items

To receive the bundle according to the technical specification, please order the items listed.



PD4-S-FC

Art.No: 92254

Voltage: 110 – 240 V AC 50 / 60 Hz

Dimensions: Ø 97 x 103 mm

Power consumption: approx. 0.2 W

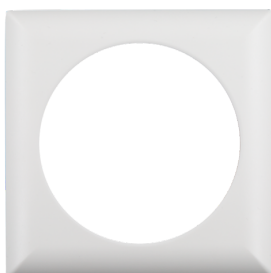

Square design frame PD4-FC

Art.No: 92992

Dimensions: 101 x 101 x 11.8 mm

Housing: polycarbonate, UV-resistant

Material color: pure white mat, similar to RAL9010