

B.E.G.**LUXOMAT®**

PD4-S-FC

Prod.No. 92254 EAN: 4007529922543

- Voltage: 110 - 240 V AC 50 / 60 Hz
- Dimensions: Ø 97 x 103 mm
- Power consumption: approx. 0.2 W

Order data

Designation	Colour	Art.No
PD4-S-FC	white	92254

Accessories

Designation	Colour	Art.No
BLE-IR-Adapter	black	93067
Square design frame PD4-FC	pure white	92992
Wire basket BSK (Ø 200 x 90 mm)	white	92199
Blinds PD4	transparent	92313

Technical data

Voltage:	110 - 240 V AC 50 / 60 Hz
Dimensions:	Ø 97 x 103 mm
Power consumption:	approx. 0.2 W
Detection area:	horizontal 360° (Ceiling mounting) max. Ø 24 m across
Range:	max. Ø 8 m towards max. Ø 6.4 m seated
Monitored area (tangential movement):	450 m ² / 2.5 m mounting height
Mounting height min./max./recommended:	2 m / 10 m / 2.5 m
Degree / class of protection:	IP20 / Class II
Impact strength:	IK04
Ambient temperature:	-25 °C to +50 °C
Housing:	polycarbonate, UV-resistant
Material color:	white mat, similar to RAL9010
Pulse interval:	2 or 9 sec

Product information

Slave device detector with extended detection area

For extending the detection area of a Master device

Trigger pulse to master device upon detected movement
independent of the ambient light level

Compatible with 230 V devices. Concerning exceptions please
see the respective master device.

Application examples:

open-plan offices, conference rooms, classrooms/seminar
rooms, staircases, small offices, sports halls/ storage rooms

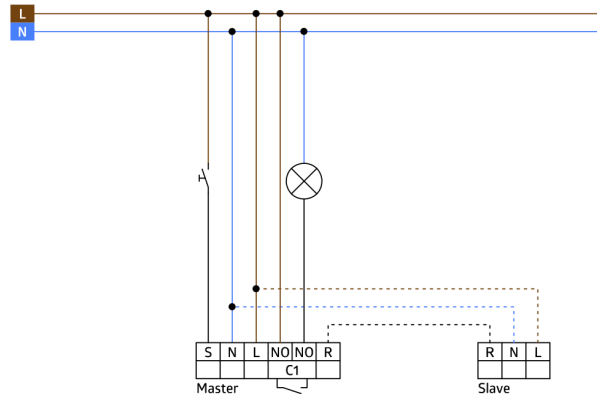
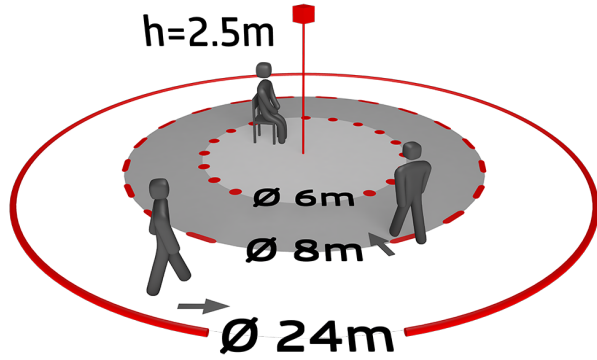
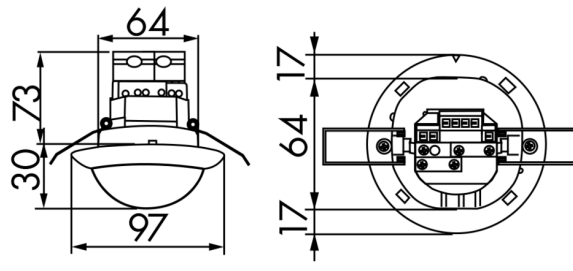

Accessories



BLE-IR-Adapter

Art.No: 93067

Dimensions: 40 x 55 x 103 mm

Material color: black

Frequency: 2.4 GHz ISM band, GFSK 0.2 dBm
+ 5.3 dBi = 5.5 dBm

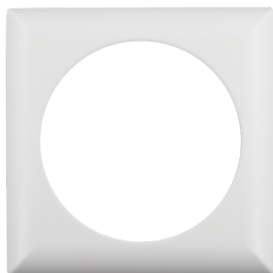

Square design frame PD4-FC

Art.No: 92992

Dimensions: 101 x 101 x 11.8 mm

Housing: polycarbonate, UV-resistant

Material color: pure white mat,
similar to RAL9010

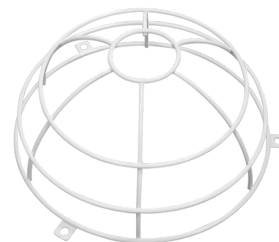

Wire basket BSK (Ø 200 x 90 mm)

Art.No: 92199

Dimensions: Ø 200 x 90 mm

Impact strength: IK09

Housing: coated steel basket



Blinds PD4

Art.No: 92313

Housing: Housing UV- and shockresistant

Polycarbonate

Material color: transparent