

B.E.G.**LUXOMAT®**

PD4-S-C-FC Set 92444-92199

- Voltage: 110 - 240 V AC 50 / 60 Hz
- Dimensions: **Ø 200 x 90 mm (92199)**
- Power consumption: approx. 0.2 W

Order data

Designation	Colour	Art.No
PD4-S-C-FC	white	92444
Wire basket BSK (Ø 200 x 90 mm)	white	92199

Technical data

Voltage:	110 - 240 V AC 50 / 60 Hz
Dimensions:	Ø 200 x 90 mm (92199)
Power consumption:	approx. 0.2 W horizontal 360°
Detection area:	(Ceiling mounting) max. Ø 40 m across
Range:	max. Ø 20 m towards
Monitored area (tangential movement):	250 m ² / 2.5 m mounting height
Mounting height min./max./recommended:	2.4 m / 2.6 m / 2.5 m
Degree / class of protection:	IP20 / Class II
Impact strength:	IK09 (92199)
Ambient temperature:	-25 °C to +50 °C
Housing:	polycarbonate, UV-resistant + coated steel basket (92199)
Material color:	white mat, similar to RAL9010
Pulse interval:	2 or 9 sec

Product information

Set : PD4-S-C-FC + Wire basket BSK (Ø 200 x 90 mm)
white

Slave device detector designed for corridors

For extending the detection area of a Master device

Trigger pulse to master device upon detected movement
independent of the ambient light level

Compatible with 230 V devices. Concerning exceptions please
see the respective master device.

There are markings to ensure correct alignment during
installation

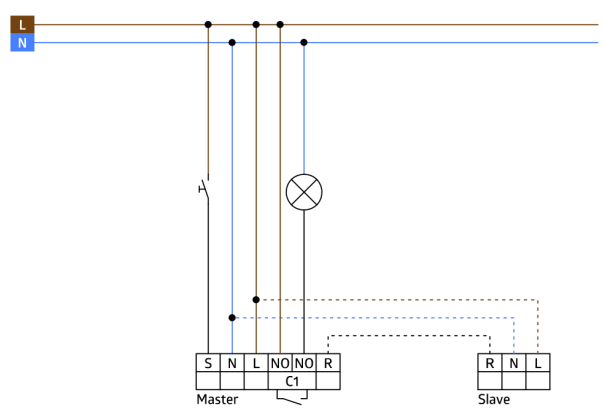
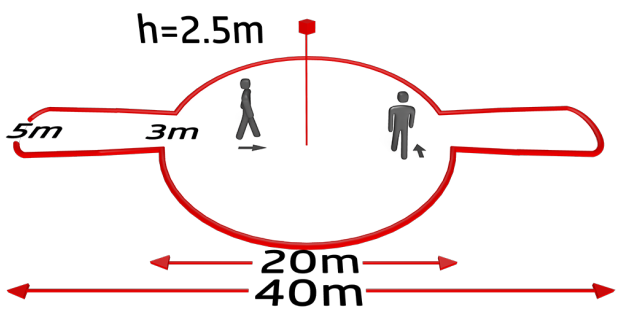
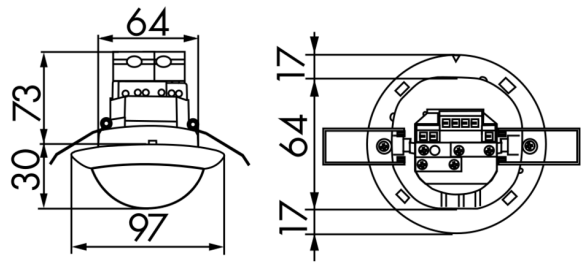

Set items

To receive the bundle according to the technical specification, please order the items listed.



PD4-S-C-FC
Art.No: 92444

Voltage: 110 – 240 V AC 50 / 60 Hz
Dimensions: Ø 97 x 103 mm
Power consumption: approx. 0.2 W



Wire basket BSK (Ø 200 x 90 mm)
Art.No: 92199

Dimensions: Ø 200 x 90 mm
Impact strength: IK09
Housing: coated steel basket