

B.E.G.

LUXOMAT®



BL2-PLUS-FC Set 93405-93251-92199

- Voltage: 110 - 240 V 50 / 60 Hz
- Dimensions: **Ø 200 x 90 mm (92199)**
- Power consumption: 0.3 W

Order data

| Designation | Colour | Art.No |
|---------------------------------|--------|--------|
| BL2-PLUS-FC | white | 93405 |
| Mounting set BL2-FM | white | 93251 |
| Wire basket BSK (Ø 200 x 90 mm) | white | 92199 |

Technical data

| | |
|--|---|
| Voltage: | 110 - 240 V 50 / 60 Hz |
| Dimensions: | Ø 200 x 90 mm (92199) |
| Power consumption: | 0.3 W |
| Detection area: | horizontal 360° (Ceiling mounting) max. Ø 8 m across max. Ø 4.8 m towards seated |
| Range: | |
| Monitored area (tangential movement): | 50 m ² / 2.5 m mounting height |
| Mounting height min./max./recommended: | 2 m / 5 m / 2.5 m |
| Degree / class of protection: | IP23 / Class II |
| Ambient temperature: | -25 °C to +50 °C |
| Housing: | polycarbonate, UV-resistant + coated steel basket (92199) |
| Material color: | white |
| Connections and wires: | 0.5 - 1.5 mm ² for solid conductors |

Channel 1 (lighting control)

| | |
|----------------------|---|
| Switching power: | 1000 W, cos φ = 1 500 VA, cos φ = 0.5 400 W LED |
| Type of contact (k): | 1x μ -contact, NO contact |
| Follow-up time: | 15 sec - 30 min |
| Switch-on threshold: | 10 - 2000 Lux |

Product information

Set : BL2-PLUS-FC + Mounting set BL2-FM white + Wire basket BSK (Ø 200 x 90 mm) white

Remote control-capable occupancy detector for inside use with circular detection area

For mounting in suspended ceilings

One channel for light switching

Manual switching via push-button possible

Basic functions for cost-effective applications

Ready-to-operate thanks to factory settings

Accessory for surface mounting and flush mounting available

Factory setting: High detection sensitivity, follow-up time 10 min, switch-on threshold 500 lux

Easy operation with remote control (required)

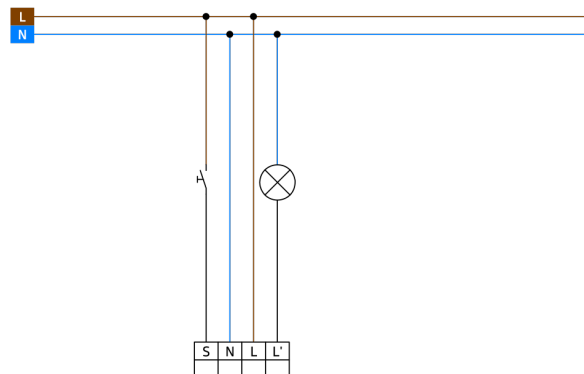
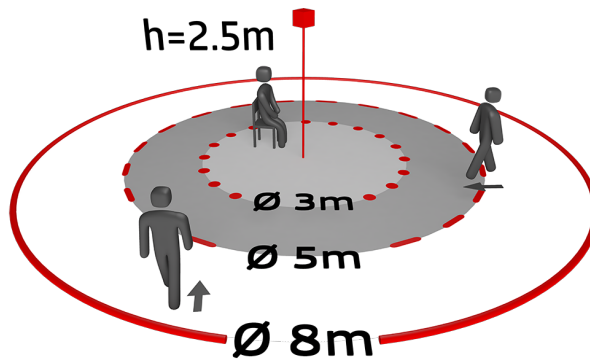
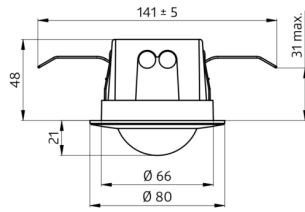

Set items

To receive the bundle according to the technical specification, please order the items listed.



BL2-PLUS-FC
Art.No: 93405

Voltage: 110 – 240 V 50 / 60 Hz
Dimensions: Ø 80 x 61 mm
Power consumption: 0.3 W



Mounting set BL2-FM
Art.No: 93251

Dimensions: Ø 104 x 19 mm
Material color: white

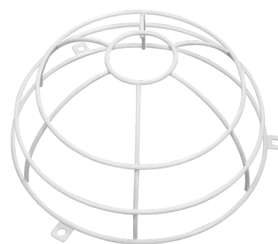

Wire basket BSK (Ø 200 x 90 mm)
Art.No: 92199

Dimensions: Ø 200 x 90 mm
Impact strength: IK09
Housing: coated steel basket